

ANSI VALVE & FLANGE

PRODUCT OVERVIEW

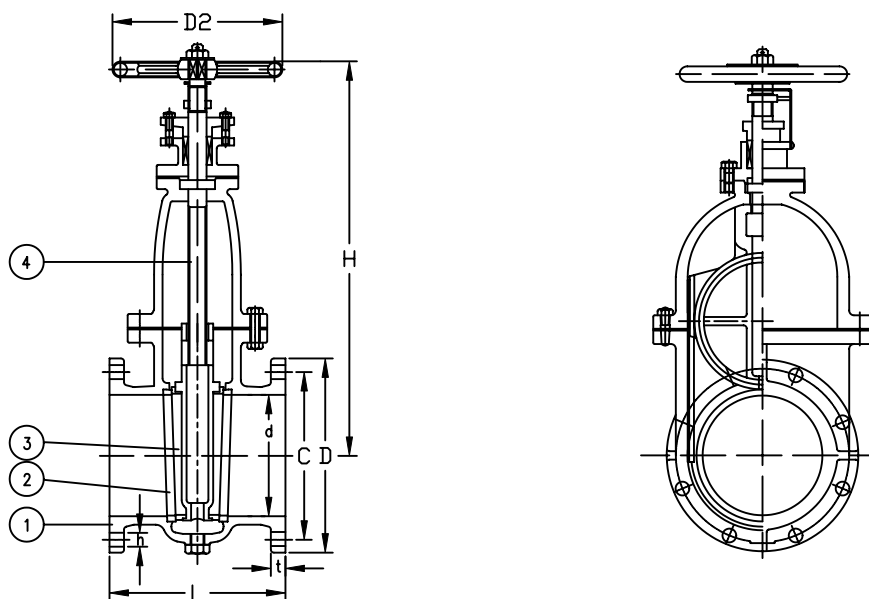

Series 1021 ... Regular



Face to face acc. to ANSI B16.10
Flanges acc. to ANSI B16.24 Class 150

Part Nr.	Material (Option 1)	Material (Option 2)	Hydraulic Inspection	
			Shell	Seat
1 - Body	Bronze - B62	Bronze - B62	350 PSIG	225 PSIG
2 - Seat Ring	Bronze - B62	St. Steel - SS304		
3 - Disc Ring	Bronze - B62	St. Steel - SS304		
4 - Stem	Brass - B124	Brass - B124		

	Size	L	D	C	n	h	t	H	D2	Lb Kg
in	2	7.00	6.00	4.75	4	0.75	0.50	11.25	5.00	32
mm	50	178	152	121		19	13	286	127	15
in	2.50	7.50	7.00	5.50	4	0.75	0.56	13.00	5.50	44
mm	65	191	178	140		19	14	330	140	20
in	3	8.00	7.50	6.00	4	0.75	0.62	13.00	6.31	53
mm	80	203	191	152		19	16	330	160	24
in	4	9.00	9.00	7.50	8	0.75	0.68	17.00	7.12	84
mm	100	229	229	191		19	17	432	181	38
in	5	10.00	10.00	8.50	8	0.88	0.75	19.50	7.88	114
mm	125	254	254	216		22	19	495	200	52
in	6	10.50	11.00	9.50	8	0.88	0.80	22.00	8.88	154
mm	150	267	279	241		22	20	559	225	70
in	8	11.50	13.50	11.75	8	0.88	0.94	26.75	11.00	268
mm	200	292	343	298		22	24	679	279	122
in	10	13.00	16.00	14.25	12	1.00	1.00	31.50	14.00	420
mm	250	330	406	362		25	25	800	356	191
in	12	14.00	19.00	17.00	12	1.00	1.06	33.25	15.00	636
mm	300	356	483	432		25	27	845	381	289

Series 2021 ... Regular
Series 2121 ... SDNR

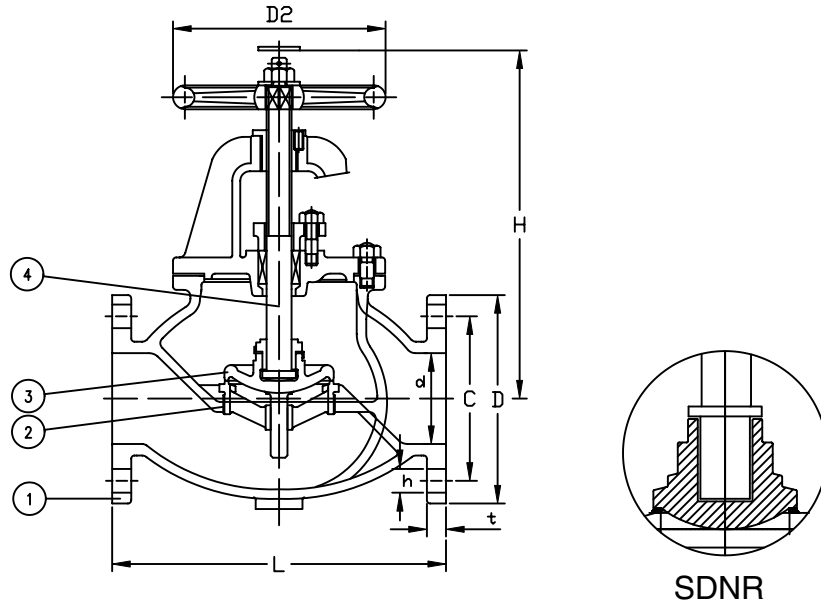

Face to face acc. to ANSI B16.10
Flanges acc. to ANSI B16.24 Class 150

Part Nr.	Material (Option 1)	Material (Option 2)	Hydraulic Inspection	
			Shell	Seat
1 - Body	Bronze - B62	Bronze - B62	350 PSIG	225 PSIG
2 - Seat Ring	Bronze - B62	St. Steel - SS304		
3 - Disc Ring	Bronze - B62	St. Steel - SS304		
4 - Stem	Brass - B124	Brass - B124		

	Size	L	D	C	n	h	t	H	D2	Lb Kg
in mm	1.5 40	6.50 165	5.00 127	3.88 99	4	0.63 16	0.44 11	9.00 229	5.00 127	15 7
in mm	2 50	8.00 203	6.00 152	4.75 121	4	0.75 19	0.50 13	11.12 282	6.00 152	24 11
in mm	2.5 65	8.50 216	7.00 178	5.50 140	4	0.75 19	0.56 14	12.00 305	7.50 191	37 17
in mm	3 80	9.50 241	7.50 191	6.00 152	4	0.75 19	0.63 16	14.75 375	8.75 222	51 23
in mm	4 100	11.50 292	9.00 229	7.50 191	8	0.75 19	0.69 18	15.38 391	9.00 229	88 40
in mm	5 125	14.00 356	10.00 254	8.50 216	8	0.88 22	0.75 19	18.25 464	10.00 254	123 56
in mm	6 150	16.00 406	11.00 279	9.50 241	8	0.88 22	0.81 21	21.50 546	12.00 305	183 83
in mm	8 200	19.50 495	13.50 343	11.75 298	8	0.88 22	0.94 24	27.25 692	14.00 356	275 125

Series 3021 ... Regular
Series 3121 ... SDNR

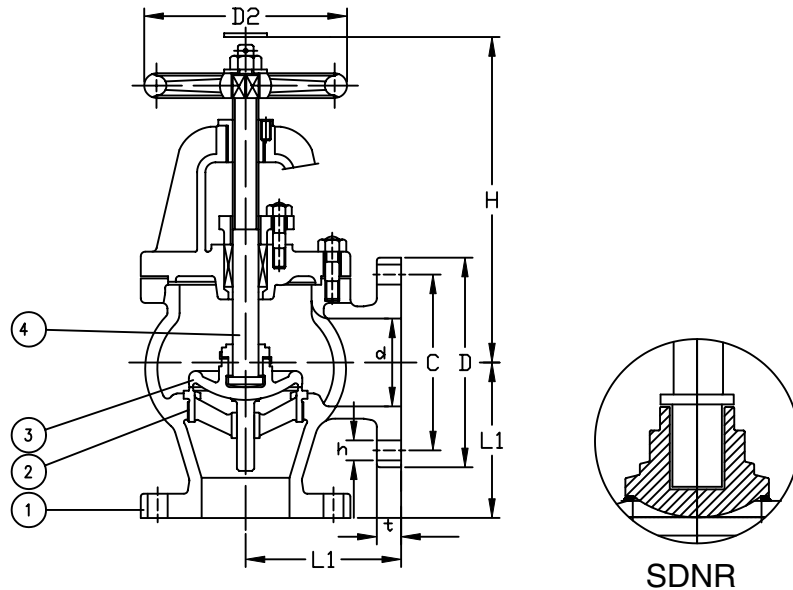

Face to center acc. to ANSI B16.10
Flanges acc. to ANSI B16.24 Class 150

Part Nr.	Material (Option 1)	Material (Option 2)	Hydraulic Inspection	
			Shell	Seat
1 - Body	Bronze - B62	Bronze - B62	350 PSIG	225 PSIG
2 - Seat Ring	Bronze - B62	St. Steel - SS304		
3 - Disc Ring	Bronze - B62	St. Steel - SS304		
4 - Stem	Brass - B124	Brass - B124		

	Size	L	D	C	n	h	t	H	D2	Lb Kg
in mm	1.5 40	3.25 83	5.00 127	3.88 99	4	0.63 16	0.44 11	9.00 229	5.00 127	22 10
in mm	2 50	4.00 102	6.00 152	4.75 121	4	0.75 19	0.50 13	11.12 282	6.00 152	33 15
in mm	2.5 65	4.25 108	7.00 178	5.50 140	4	0.75 19	0.56 14	12.00 305	7.50 191	44 20
in mm	3 80	4.75 121	7.50 191	6.00 152	4	0.75 19	0.63 16	14.75 375	8.75 222	44 24
in mm	4 100	5.75 146	9.00 229	7.50 191	4	0.75 19	0.69 18	15.38 391	9.00 229	84 38
in mm	5 125	7.00 178	10.00 254	8.50 216	8	0.75 19	0.75 19	18.25 464	10.00 254	114 52
in mm	6 150	8.00 203	11.00 279	9.50 241	8	0.88 22	0.81 21	21.50 546	12.00 305	154 70
in mm	8 200	9.00 229	13.50 343	11.75 298	8	0.88 22	0.94 24	27.25 692	14.00 356	266 121

Series 4421 ... Swing Check

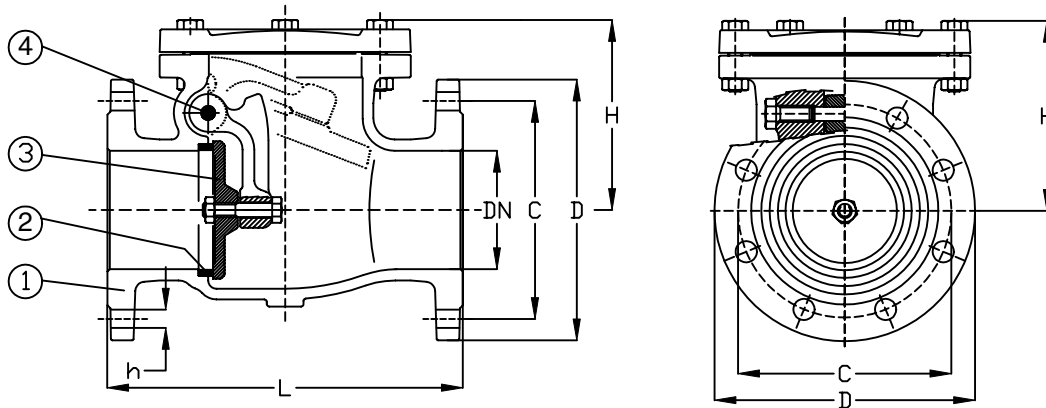

Face to face acc. to ANSI B16.10
Flanges acc. to ANSI B16.24 Class 150

Part Nr.	Material (Option 1)	Material (Option 2)	Hydraulic Inspection	
			Shell	Seat
1 - Body	Bronze - B62	Bronze - B62	350 PSIG	225 PSIG
2 - Seat Ring	Bronze - B62	St. Steel - SS304		
3 - Disc Ring	Bronze - B62	St. Steel - SS304		
4 - Hinge	Brass - B124	Brass - B124		

	Size	L	D	C	n	h	t	H	Lb Kg
in mm	2 50	8.00 203	6.00 152	4.75 121	4	0.75 19	0.50 13	5.50 140	42 19
in mm	2.50 65	8.50 216	7.00 178	5.50 140	4	0.75 19	0.56 14	6.00 152	51 23
in mm	3 80	9.50 241	7.50 191	6.00 152	4	0.75 19	0.62 16	6.50 165	73 33
in mm	4 100	11.50 292	9.00 229	7.50 191	8	0.75 19	0.68 17	7.88 200	106 48
in mm	5 125	13.00 330	10.00 254	8.50 216	8	0.88 22	0.75 19	8.38 213	185 84
in mm	6 150	14.00 356	11.00 279	9.50 241	8	0.88 22	0.80 20	9.50 241	330 150
in mm	8 200	19.50 495	13.50 343	11.75 298	8	0.88 22	0.94 24	10.50 267	484 220
in mm	10 250	24.50 622	16.00 406	14.25 362	12	1.00 25	1.00 25	13.38 340	704 320
in mm	12 300	27.50 698	19.00 483	17.00 432	12	1.00 25	1.06 27	15.35 390	913 415

Series 7334G ... Globe
Series 7334A ... Angle

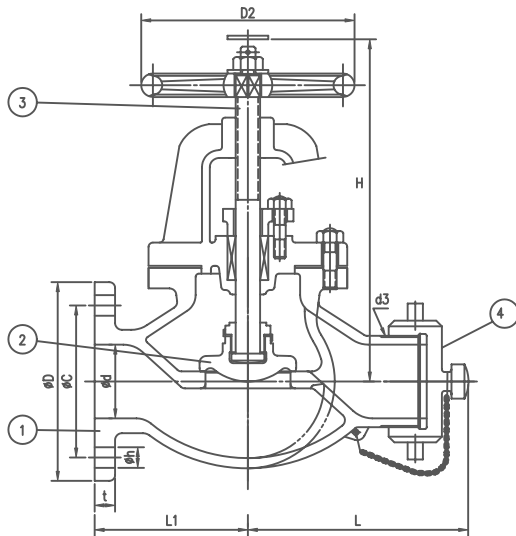

Globe Pattern

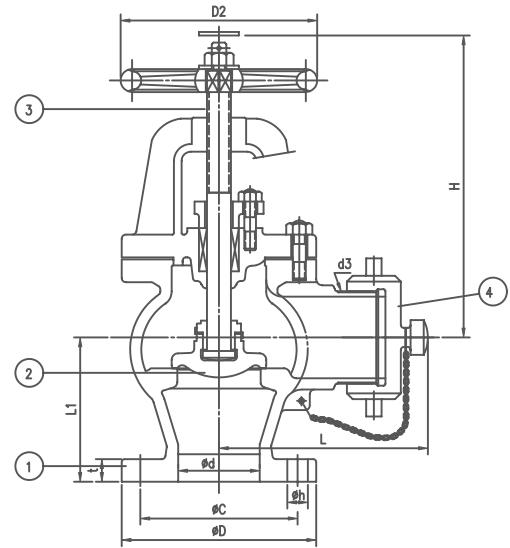

Angle Pattern

Flanges acc. to ANSI B16.24 Class 150

Other thread connections available upon request Size 1.5" (40mm) will be supplied with a Screwed Bonnet (not pictured)

Part Nr.	Material (Option 1)	Material (Option 2)	Hydraulic Inspection	
			Shell	Seat
1 - Body	Bronze - B62	Bronze - B62	350 PSIG	225 PSIG
2 - Disc	Bronze - B62	SS304 - SS304		
3 - Stem	Brass - B124	SS304 - SS304		
4 - Cap	Bronze - B62	Bronze - B62		

			Size	L	L1	D	C	n	h	t	H	D2	D3
Globe Pattern	Class 150#	in	1.5	4.13	3.54	5.00	3.88	4	0.63	0.44	7.48	5.51	9.5 NH
		mm	40	105	90	127	99		16	11	190	140	(NST)
	Class 300#	in	2	5.50	4.33	6.00	4.75	4	0.75	0.50	10.63	6.30	8 NH
		mm	50	140	110	152	121		19	13	270	160	(NST)
Angle Pattern	Class 150#	in	2.5	6.50	5.31	7.00	5.50	4	0.75	0.56	11.61	7.87	7 NH
		mm	65	165	135	178	140		19	14	295	200	(NST)
	Class 300#	in	2.5	7.00	5.70	7.50	6.00	8	.90	0.81	12.00	7.87	7 NH
		mm	65	178	145	190	152		23	20	305	200	(NST)
Globe Pattern	Class 150#	in	1.5	3.74	3.94	5.00	3.88	4	0.63	0.44	6.50	5.51	9.5 NH
		mm	40	95	100	127	99		16	11	165	140	(NST)
	Class 300#	in	2	5.12	4.72	6.00	4.75	4	0.75	0.50	9.45	6.30	8 NH
		mm	50	130	120	152	121		19	13	240	160	(NST)
Angle Pattern	Class 150#	in	2.5	6.50	5.12	7.00	5.50	4	0.75	0.56	10.04	7.87	7 NH
		mm	65	165	130	178	140		19	14	255	200	(NST)
	Class 300#	in	2.5	7.00	5.60	7.50	6.00	8	.90	0.81	11.50	7.87	7 NH
		mm	65	178	142	190	152		23	20	270	200	(NST)

Conversion Table - Linear

From Inches to Millimeters

1 Inch = 25.4mm

Inch	0	1/16	1/8	3/16	1/4	5/16	3/8	7/16	1/2	9/16	5/8	11/16	3/4	13/16	7/8	15/16
0	mm	1.6	3.2	4.8	6.4	7.9	9.5	11.1	12.7	14.3	15.9	17.5	19.1	20.6	22.2	23.8
1	25.4	27.0	28.6	30.2	31.8	33.3	34.9	36.5	38.1	39.7	41.3	42.9	44.5	46.0	47.6	49.2
2	50.8	52.4	54.0	55.6	57.2	58.7	60.3	61.9	63.5	65.1	66.7	68.3	69.9	71.4	73.0	74.6
3	76.2	77.8	79.4	81.0	82.6	84.1	85.7	87.3	88.9	90.5	92.1	93.7	95.3	96.8	98.4	100.0
4	101.6	103.2	104.8	106.4	108.0	109.5	111.1	112.7	114.3	115.9	117.5	119.1	120.7	122.2	123.8	125.4
5	127.0	128.6	130.2	131.8	133.4	134.9	136.5	138.1	139.7	141.3	142.9	144.5	146.1	147.6	149.2	150.8
6	152.4	154.0	155.6	157.2	158.8	160.3	161.9	163.5	165.1	166.7	168.3	169.9	171.5	173.0	174.6	176.2
7	177.8	179.4	181.0	182.6	184.2	185.7	187.3	188.9	190.5	192.1	193.7	195.3	196.9	198.4	200.0	201.6
8	203.2	204.8	206.4	208.0	209.6	211.1	212.7	214.3	215.9	217.5	219.1	220.7	222.3	223.8	225.4	227.0
9	228.6	230.2	231.8	233.4	235.0	236.5	238.1	239.7	241.3	242.9	244.5	246.1	247.7	249.2	250.8	252.4
10	254.0	255.6	257.2	258.8	260.4	261.9	263.5	265.1	266.7	268.3	269.9	271.5	273.1	274.6	276.2	277.8
11	279.4	281.0	282.6	284.2	285.8	287.3	288.9	290.5	292.1	293.7	295.3	296.9	298.5	300.0	301.6	303.2
12	304.8	306.4	308.0	309.6	311.2	312.7	314.3	315.9	317.5	319.1	320.7	322.3	323.9	325.4	327.0	328.6
13	330.2	331.8	333.4	335.0	336.6	338.1	339.7	341.3	342.9	344.5	346.1	347.7	349.3	350.8	352.4	354.0
14	355.6	357.2	358.8	360.4	362.0	363.5	365.1	366.7	368.3	369.9	371.5	373.1	374.7	376.2	377.8	379.4
15	381.0	382.6	384.2	385.8	387.4	388.9	390.5	392.1	393.7	395.3	396.9	398.5	400.1	401.6	403.2	404.8
16	406.4	408.0	409.6	411.2	412.8	414.3	415.9	417.5	419.1	420.7	422.3	423.9	425.5	427.0	428.6	430.2
17	431.8	433.4	435.0	436.6	438.2	439.7	441.3	442.9	444.5	446.1	447.7	449.3	450.9	452.4	454.0	455.6
18	457.2	458.8	460.4	462.0	463.6	465.1	466.7	468.3	469.9	471.5	473.1	474.7	476.3	477.8	479.4	481.0
19	482.6	484.2	485.8	487.4	489.0	490.5	492.1	493.7	495.3	496.9	498.5	500.1	501.7	503.2	504.8	506.4
20	508.0	509.6	511.2	512.8	514.4	515.9	517.5	519.1	520.7	522.3	523.9	525.5	527.1	528.6	530.2	531.8
21	533.4	535.0	536.6	538.2	539.8	541.3	542.9	544.5	546.1	547.7	549.3	550.9	552.5	554.0	555.6	557.2
22	558.8	560.4	562.0	563.6	565.2	566.7	568.3	569.9	571.5	573.1	574.7	576.3	577.9	579.4	581.0	582.6
23	584.2	585.8	587.4	589.0	590.6	592.1	593.7	595.3	596.9	598.5	600.1	601.7	603.3	604.8	606.4	608.0
24	609.6	611.2	612.8	614.4	616.0	617.5	619.1	620.7	622.3	623.9	625.5	627.1	628.7	630.2	631.8	633.4
25	635.0	636.6	638.2	639.8	641.4	642.9	644.5	646.1	647.7	649.3	650.9	652.5	654.1	655.6	657.2	658.8

Example:

In order to obtain the millimeter (mm) dimension for 7-1/2", find 7" on the x (vertical) axis and 1/2" on the y (horizontal) axis of the chart. The intersection of the two numbers is the millimeter (mm) equivalent to 7-1/2" (or 190.50mm).

Conversion Table - Pressure

From PSI to Kg/Cm2 and Kg/Cm2 to PSI

PSI	Kg/Cm2	PSI	Kg/Cm2	PSI	Kg/Cm2	PSI	Kg/Cm2	PSI	Kg/Cm2	PSI	Kg/Cm2	PSI	Kg/Cm2	PSI	Kg/Cm2
1	0.07	31	2.18	61	4.29	91	6.40	205	14.42	410	28.83	710	49.93	1010	71.03
2	0.14	32	2.25	62	4.36	92	6.47	210	14.77	420	29.54	720	50.63	1020	71.73
3	0.21	33	2.32	63	4.43	93	6.54	215	15.12	430	30.24	730	51.34	1030	72.43
4	0.28	34	2.39	64	4.50	94	6.61	220	15.47	440	30.94	740	52.04	1040	73.14
5	0.35	35	2.46	65	4.57	95	6.68	225	15.82	450	31.65	750	52.74	1050	73.84
6	0.42	36	2.53	66	4.64	96	6.75	230	16.17	460	32.35	760	53.45	1060	74.54
7	0.49	37	2.60	67	4.71	97	6.82	235	16.53	470	33.05	770	54.15	1070	75.25
8	0.56	38	2.67	68	4.78	98	6.89	240	16.88	480	33.76	780	54.85	1080	75.95
9	0.63	39	2.74	69	4.85	99	6.96	245	17.23	490	34.46	790	55.56	1090	76.65
10	0.70	40	2.81	70	4.92	100	7.03	250	17.58	500	35.16	800	56.26	1100	77.36
11	0.77	41	2.88	71	4.99	105	7.38	255	17.93	510	35.86	810	56.96	1120	78.76
12	0.84	42	2.95	72	5.06	110	7.74	260	18.28	520	36.57	820	57.67	1140	80.17
13	0.91	43	3.02	73	5.13	115	8.09	265	18.64	530	37.27	830	58.37	1160	81.58
14	0.98	44	3.09	74	5.20	120	8.44	270	18.99	540	37.97	840	59.07	1180	82.98
15	1.05	45	3.16	75	5.27	125	8.79	275	19.34	550	38.68	850	59.77	1200	84.39
16	1.13	46	3.23	76	5.34	130	9.14	280	19.69	560	39.38	860	60.48	1220	85.79
17	1.20	47	3.31	77	5.41	135	9.49	285	20.04	570	40.08	870	61.18	1240	87.20
18	1.27	48	3.38	78	5.49	140	9.85	290	20.39	580	40.79	880	61.88	1260	88.61
19	1.34	49	3.45	79	5.56	145	10.20	295	20.75	590	41.49	890	62.59	1280	90.01
20	1.41	50	3.52	80	5.63	150	10.55	300	21.10	600	42.19	900	63.29	1300	91.42
21	1.48	51	3.59	81	5.70	155	10.90	310	21.80	610	42.90	910	63.99	1320	92.83
22	1.55	52	3.66	82	5.77	160	11.25	320	22.50	620	43.60	920	64.70	1340	94.23
23	1.62	53	3.73	83	5.84	165	11.60	330	23.21	630	44.30	930	65.40	1360	95.64
24	1.69	54	3.80	84	5.91	170	11.95	340	23.91	640	45.01	940	66.10	1380	97.05
25	1.76	55	3.87	85	5.98	175	12.31	350	24.61	650	45.71	950	66.81	1400	98.45
26	1.83	56	3.94	86	6.05	180	12.66	360	25.32	660	46.41	960	67.51	1420	99.86
27	1.90	57	4.01	87	6.12	185	13.01	370	26.02	670	47.12	970	68.21	1440	101.27
28	1.97	58	4.08	88	6.19	190	13.36	380	26.72	680	47.82	980	68.92	1460	102.67
29	2.04	59	4.15	89	6.26	195	13.71	390	27.43	690	48.52	990	69.62	1480	104.08
30	2.11	60	4.22	90	6.33	200	14.06	400	28.13	700	49.23	1000	70.32	1500	105.49

To convert to Kg/Cm2 from PSI, divide PSI by 14.22

To convert to PSI from Kg/Cm2, multiply Kg/Cm2 by 14.22

RETURN OF GOODS TERMS & CONDITIONS

Customer may return new, unused items sold and fulfilled by World Wide Metric in accordance with the guidelines below:

- A copy of the return authorization issued by World Wide Metric must accompany material being returned for credit.
- Material must be returned Freight Prepaid unless otherwise specified by World Wide Metric. Collect Freight Shipments will be refused.
- Material returned must be in the same condition as supplied. Please make sure that there is adequate packing when returning materials to prevent damage during transit. Any damage incurred during transit is the responsibility of the shipper. Upon inspection of material, credit will be applied provided the material is free of any damage or wear.
- A restocking charge may be incurred on returned shipments.
- World Wide Metric reserves the right to refuse any unauthorized returns at the customer's expense.
- We cannot accept returns of the following items:
 - Items that were originally invoiced 90 days prior to the return
 - Items that we customized
 - Items that were special ordered

If you have any questions, please contact your local World Wide Metric sales representative.

worldwidemetric.com
sales@worldwidemetric.com

Headquarters/Eastern Region:

37 Readington Road
Branchburg, NJ 08876
Phone: (732) 247-2300
Fax: (732) 247-7258
Toll free: 855-CALL-WWM (855-255-5996)

Southeast Region:

3402 S.W. 26th Terrace
Suite B-11
Ft. Lauderdale, FL 33312
Phone: (954) 321-0784
Fax: (954) 321-2591

Gulf Region:

2103 E. Governors Circle
Houston, TX 77092
Phone: (713) 682-2400
Fax: (713) 682-2481

Midwest Region:

11853 Belden Court
Livonia, MI 48150
Phone: (734) 206-4350
Fax: (734) 293-4235

Western Region:

16360 Downey Avenue
Paramount, CA 90723
Phone: (562) 633-4141
Fax: (562) 633-3280

